



TERMO

Connection packs

Connection packs

For FRT, FRB, FRZ, FRK, FRM

Connection packs for easy front or side connection with time-tested valves and fittings. Each pack includes a thermostatic valve, installed at the inlet of the lamellar heat exchanger, an electrothermal actuator for flow control, return and control fittings for hydraulic resistance setting and, if required, an extension piece with elbows.



Z-TS24



Z-TF001



Z-TD001



Z-RD001



Fittings

(Z-TS24-5m, Z-TS230)

Connection to the room

Pack No.	Connection drawing	Trench heater type	Trench heater length	Flow control	Thermostatic valve	LockShield valve	Connection pack:
NP1		FRT, FRB, FRZ, FRK, FRM	< 2900 mm	Z-TS24	Z-TD001 direct	Z-RD001 direct	Extension piece: 40 and 50 mm Elbow: 2× 90°
NP2		FRT, FRB, FRZ, FRK, FRM	≥ 2900 mm	Z-TS24-5m			
NP3		FRK, FRM	all	Z-TS230			
NP5		FRK, FRM	all	Z-TF001			

Side connection

Pack No.	Connection drawing	Trench heater type	Trench heater length	Flow control	Thermostatic valve	LockShield valve	Connection pack:
NP11		FRT, FRB, FRZ, FRK, FRM	< 2900 mm	Z-TS24	Z-TD001 direct	Z-RD001 direct	is not
NP12		FRT, FRB, FRZ, FRK, FRM	≥ 2900 mm	Z-TS24-5m			
NP13		FRK, FRM	all	Z-TS230			
NP15		FRK, FRM	all	Z-TF001			

Easy Connection Set NEW PRODUCT

Quick and easy connection to the heating system. Suitable for construction sites where time and quick installation is paramount. Available for all types of convectors.

Reason to use Easy Connection Set

- > convenient installation – all components connected; pressure tested
- > no separate component specification and orders required, error prevention
- > trench heater designed for quick installation
- > delayed orders, priority given to fast installation
- > delays in construction, penalty prevention
- > shortage of plumbing companies or other professions



NOTICE: The Easy Connection Set must be ordered with the trench heater. The trench heaters are designed for use with the Easy Connection Set. The set is not compatible with standard trench heaters.

To order the **Easy Connection Set** and **modified trench heater**, mark F or K in the code at position 21.

Connection to the room

Coding at position 21	Resulting connection
F Left-side connection	
K Right-side connection	

Included components

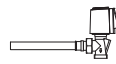

Heating medium inlet

- > axial thermostatic valve
- > electrothermal actuator*
- > pipe for connection to the heating system: PEX-AL-PEX 16×2 mm



Heating medium outlet

- > closing and regulation LockShield valve, direct
- > shaped pipe for connection to the heating system: PEX-AL-PEX 16×2 mm

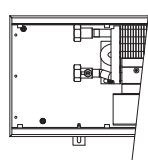

Modified trench heater

- > adapted heat exchanger connections
- > heater casing openings adapted for easy insertion and installation of the Easy Connection Set

* FRT heaters require 24 V DC electrothermal actuators, while FRK units use 230 V AC actuators; when combining FRT and FRK heaters, please indicate „all 24 V DC actuators“ in the note.

Procedure

Preparation	Step 1	Step 2	Done

Code example for the Easy Connection Set: FRT 0110 0250 1500 C 62 L2 F-5

Trench heater FRT H = 110 mm, W = 250 mm, L = 1 500 mm, „C“ Galvanized steel trough with black inside, heat exchanger and inner parts painted black, „62“ stained beech grille, transverse, roll-up, „L2“ peripheral ledge „L“ with an overlap, bronze anodized aluminium, „F“ Easy Connection Set for left-side water connection into the room (when installing the heat exchanger closer to the window, fans to the room), „5“ 24 V DC fans without controller (controller is not needed).



ISAN Radiátory s.r.o

Poříčí 26
678 01 Blansko
Česká republika

CZ&SK

+420 516 489 138
obchod@isan.cz

Export

+420 516 489 190
sales@isan.cz